

MODEL NUMBER
ZRI9M3
ZRI9M3E
ZPI80KCE
ZHI1M4E

SPECIFICATIONS	
SPECIFICATIONS	
ES NO.	DESCRIPTION
ES92-155	CONVERSION-METRIC

NOTES:

1. ALL DIMENSIONS IN MILLIMETERS AND DEGREES. [DIMENSIONS IN INCHES]

2. ALL TOLERANCES ±1.5 UNLESS OTHERWISE SPECIFIED.

3. MOUNTING KIT:

GROMMET DUROMETER	4 FOOT KIT
60-70	527-0159-00

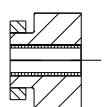
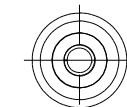

4. TUBE ENDS MUST BE SEALED.

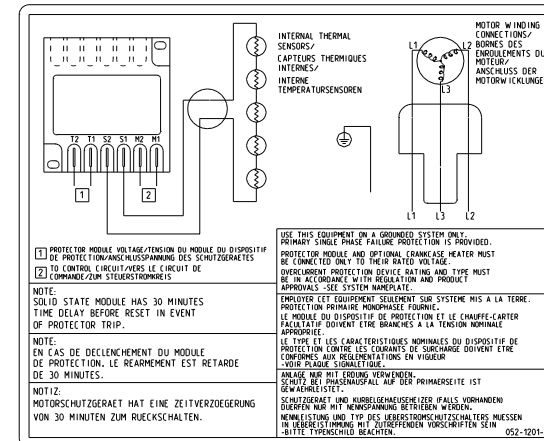

DUE TO ACCUMULATED ASSEMBLY TOLERANCES THE LISTED COMPONENTS MAY VARY FROM THE MOUNTING HOLES AS TABULATED.

SUCTION FITTING	±3.0 [0.12]
DISCHARGE FITTING	±3.0 [0.12]

EMERSON
Climate Technologies

Capeland
brand products

INTERPRET PER ASME Y14.5M-1994 AND EMERSON CLIMATE TECHNOLOGIES, INC. DESIGN STANDARDS DS2002 DO NOT SCALE DRAWING

THIRD ANGLE PROJECTION

UNLESS OTHERWISE SPECIFIED DIMENSIONS ARE MILLIMETER OR (INCH)

TOLERANCES:
1-PLACE ± 0.13 [0.005]
2-PLACE ± 0.25 [0.010]
ANGULAR ± N/A

34-0606-019	6	LOGO BLOCK .SPEC REMOVED & FORMAT CHANGED	08-20-07	SUP	BF	CHK
32-1205-032	5	REDRAWN AND REVISED	12-21-05	JYU	AF	NM
32-0399-702	0	RELEASED	09-09-02	DD	JD	JD
ENG NOTICE NO.	REV.NO.	REVISIONS	DATE	BY	CHKD	APPR
18		CONFIDENTIALITY NOTICE				
THIS DRAWING AND INFORMATION CONTAINED HEREIN ARE THE EXCLUSIVE PROPERTY OF EMERSON CLIMATE TECHNOLOGIES, INC. AND SHALL BE RETURNED UPON DEMAND AND SHALL NOT BE REPRODUCED IN WHOLE OR IN PART, DISCLOSED TO ANYONE ELSE OR USED, WITHOUT THE WRITTEN CONSENT OF EMERSON CLIMATE TECHNOLOGIES, INC.						
MATERIAL SPECIFICATION N/A			DATE 09-09-02	SUPERSEDES DWG. NO. / REV. NO. /		SCALE 1:2
TITLE REF-COMPRESSOR ASSM			DRAWING NUMBER 497-3559-00	SHEET 1 OF 1		DWG 4 SIZE